



## Creffield Road, W5

Set in very close proximity to Ealing Common and easy walking distance to Ealing Broadway is this stunning two-bedroom period conversion. The flat is situated on the first floor and spans 700 sq. ft. It boasts a 18' x 12'11" reception leading to a separate kitchen. Two large bedrooms and a stylish family sized bathroom complete the flat.

- Large two bedroom flat
- Victorian period conversion
- First floor
- Off street parking FCFS
- Share of freehold
- Short walk to Ealing Common Station
- Excellent condition through
- Communal gardens

£540,000

# Creffield Road

Approximate Gross Internal Area  
700 sq ft - 65 sq m

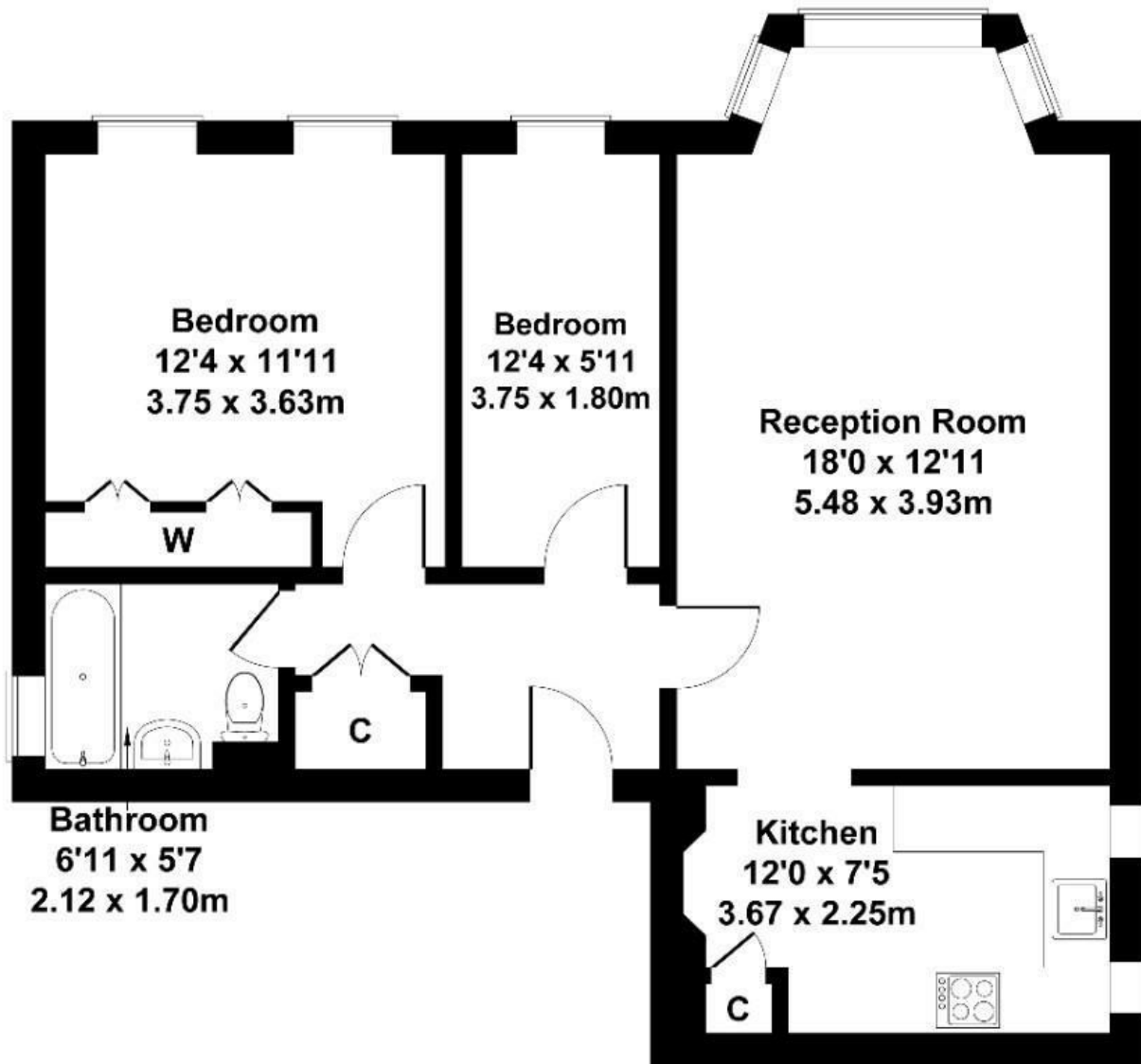

Not to Scale. Produced by The Plan Portal 2025  
For Illustrative Purposes Only.

Energy Efficiency Rating		Current	Potential
Very energy efficient - lower running costs			
(92 plus) <b>A</b>			
(81-91) <b>B</b>			
(69-80) <b>C</b>		69	
(55-68) <b>D</b>			
(39-54) <b>E</b>			
(21-38) <b>F</b>			
(1-20) <b>G</b>			
Not energy efficient - higher running costs			
<b>England &amp; Wales</b>	EU Directive 2002/91/EC		